

ShiftCam ProGrip

GETTING STARTED



Multi-Language User Manual

EN

Scan the QR code below to access our User Manual to learn how to shoot the best footage with your gear!

NL

Scan de QR-code hieronder om naar onze Gebruikershandleiding te gaan en leer hoe je de beste opnamen met onze producten kunt maken!

NO

Skann QR-koden nedenfor for å få tilgang til Brukerhåndbok for å lære hvordan du tar de beste bildene og videoene med utstyret ditt!

FR

Scannez le code QR ci-dessous pour accéder à notre Manuel de l'Utilisateur et découvrir comment prendre des images optimales avec votre matériel!

IT

Scansiona il codice QR qui sotto per accedere alla nostra manuale utente e imparare a fare le migliori riprese con il tuo equipaggiamento!

ZN

掃描QR碼進入我們網站的使用指南，您將得到完整的使用知識。

DE

Scannen Sie den QR-Code unten, um auf unseren Benutzerhandbuch zuzugreifen und zu erfahren, wie Sie mit Ihrer Ausrüstung die besten Aufnahmen machen!

SV

Skanna QR-koden nedan för att komma åt vår användarmanual där du hittar tips om hur du använder utrustningen på bästa sätt!

JP

以下のQRコードをスキャンして、取扱説明書にアクセスしてください。

FS

Escanea el siguiente código QR para acceder a nuestra Manual del usuario y aprender a hacer las mejores instantáneas con tu dispositivo!



Table of Contents

Part I	Quick Start Guide - ProGrip	P.4
	Quick Start Guide - Accessories	P.10
Part II	User Manual	P.13
Part III	Legal and Compliance	P.15



Scan the QR code to view
progrip product tutorial

Your mobile creative journey begins...



- | | | | |
|----------------------------------|---------------------------|--------------------------|--------------------------|
| A Shutter Button | D Bluetooth Button | G Cold Shoe Slot | I ¼" Tripod Screw |
| B Universal Clamp | E Charging Button | H Hand Strap Loop | J USB-C Port |
| C Wireless Charging Plate | F LED Panel | | |

Front View

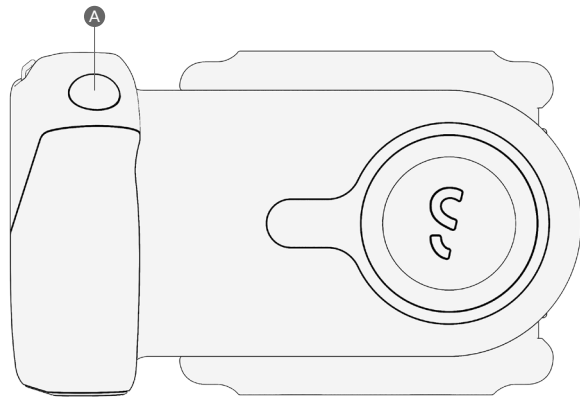

Back View

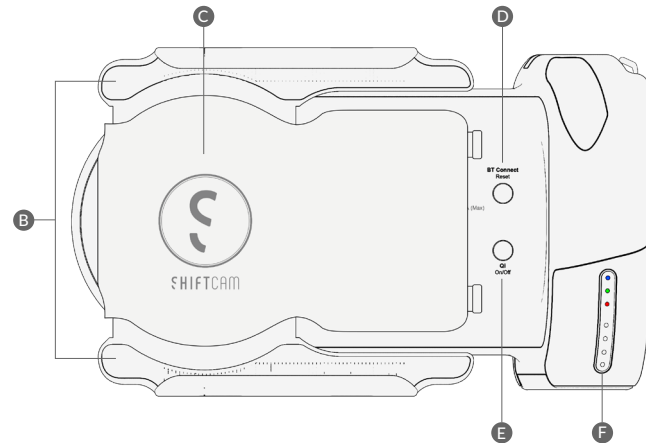

Part I

Quick Start Guide - ProGrip

Top View

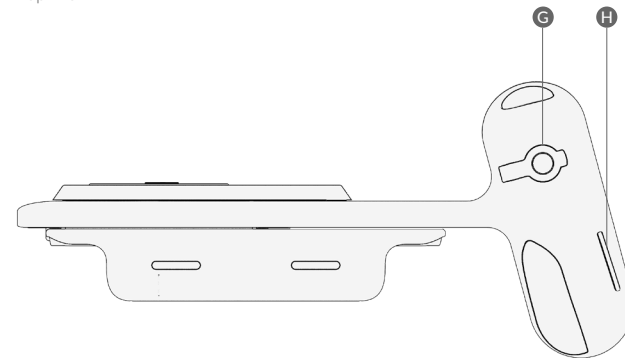

Bottom View

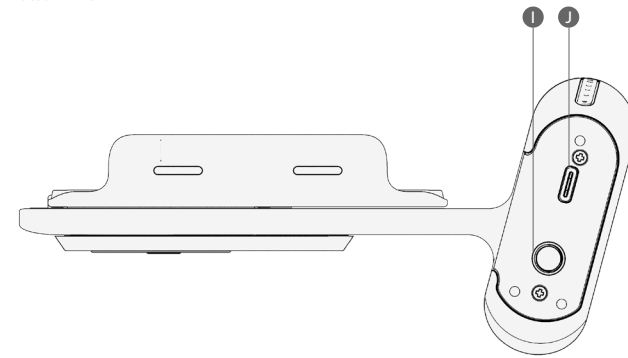

LED Panel

LED feedback indication

Bluetooth

Blink: Pairing

Solid: Connected

Wireless Charging

Solid: Wireless Charging ON

- Fast Charge

Solid: Fast Charge Available

- Battery Level

Blink: Charging (25%, 50%, 75%, 100%)



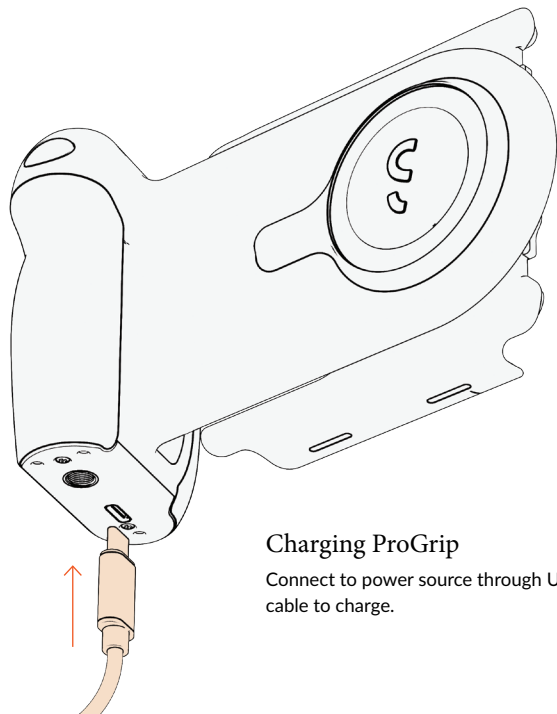

Charging ProGrip

Connect to power source through USB-C cable to charge.

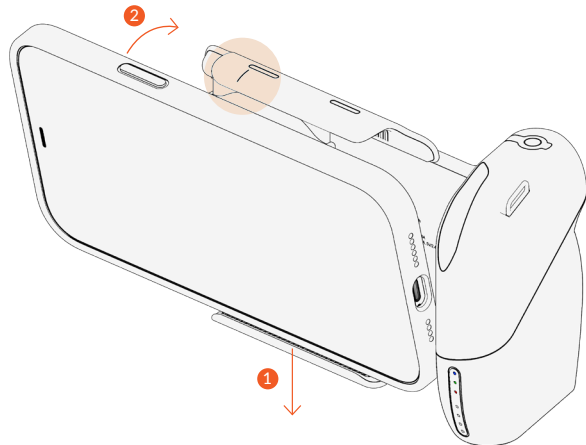

Attaching ProGrip to Phone

Align your smartphone to the center of the clamp, push down the lower arm with your smartphone to open up clamp. Push your smartphone into the top arm and release to secure.

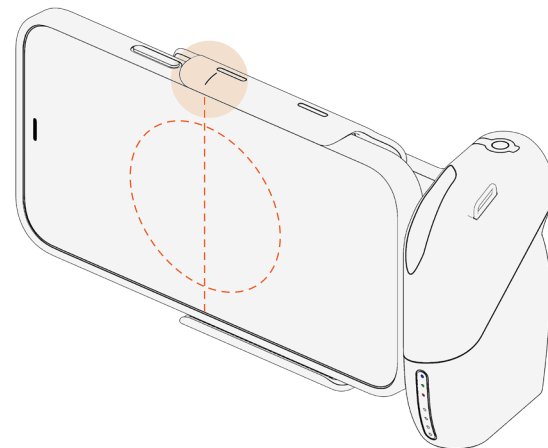

Ensure your smartphone is properly aligned to the center of the wireless charging plate for optimal charging capabilities.

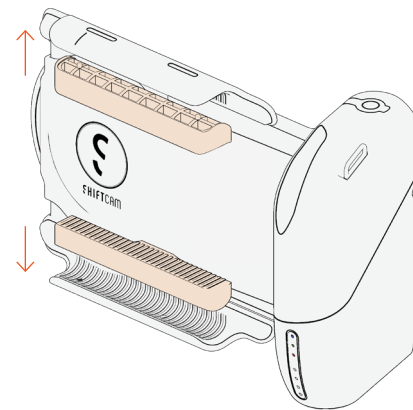

For Smaller Phone Models

If your phone's width is <75mm, add the Rubber In-lay Attachments onto the inside of the clamp to secure.

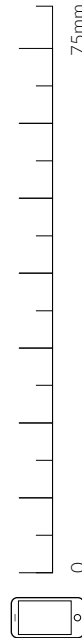

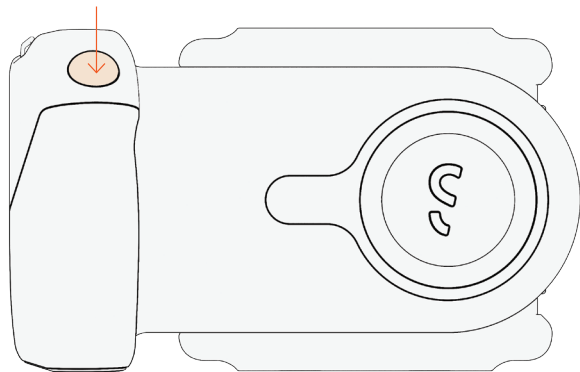

Connecting to Bluetooth Shutter

Press the shutter button and select "ShiftCam ProGrip" on your smartphone to pair. Short press to take photo, long press to take burst/video.

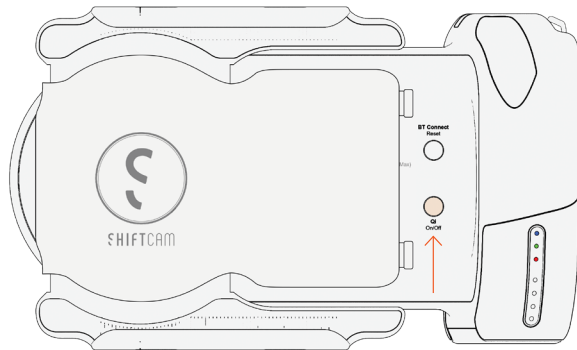

Wireless Charging

Press the Charging Button and attach your smartphone onto the ProGrip securely.

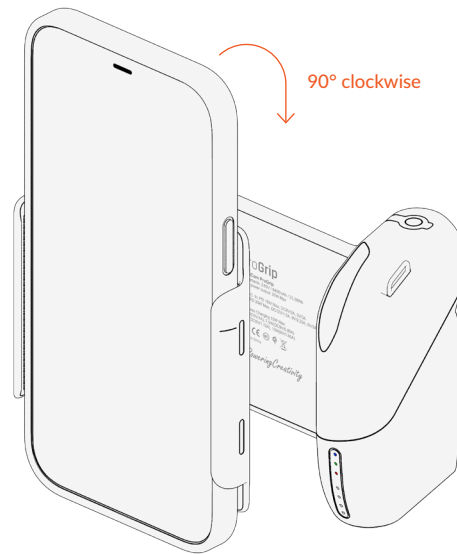

Portrait Mode

Rotate universal clamp to switch to portrait mode.

Power Bank

Charge other devices simultaneously with ProGrip using USB-C cable.

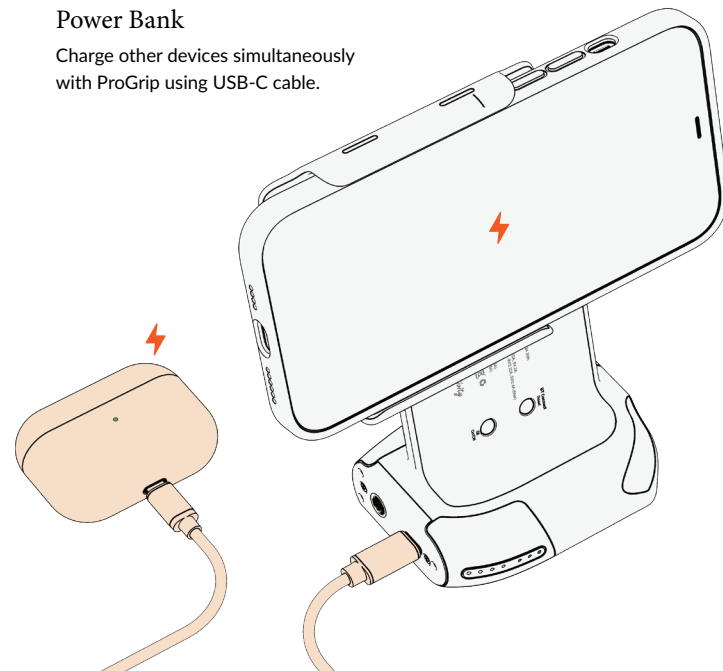

Hand Strap

Feed Hand Strap through loop and adjust length by pulling against the buckles. Screw in knob to secure.

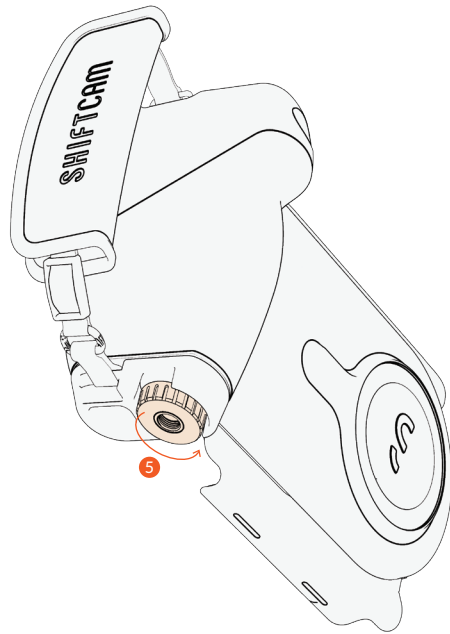
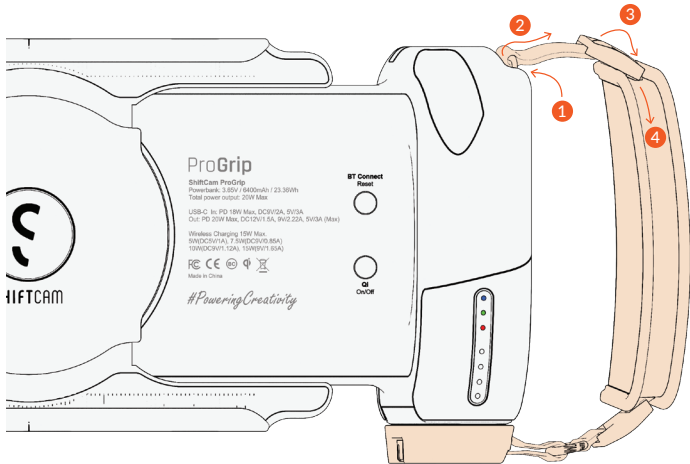

Cold Shoe Mount

Open flap and place Cold Shoe Mount on opening. Screw in knob to secure.

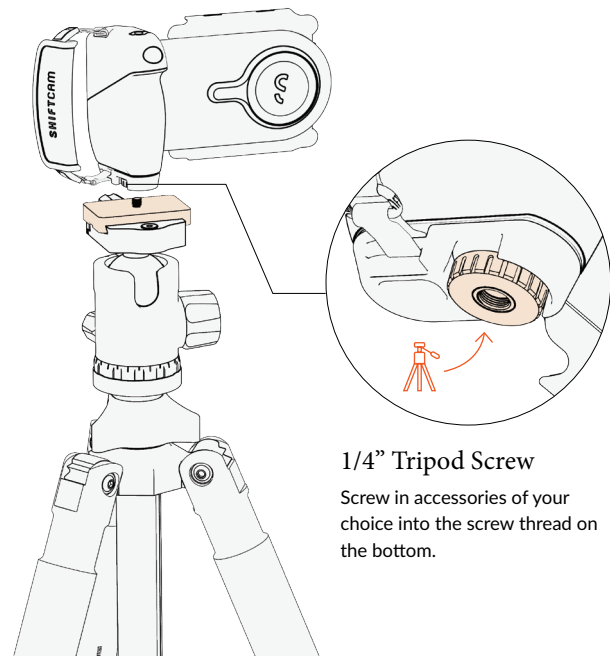

1/4" Tripod Screw

Screw in accessories of your choice into the screw thread on the bottom.

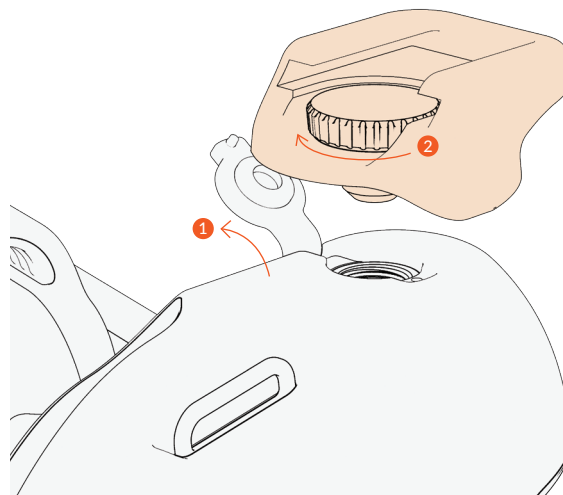



Slide and attach accessories of your choice.

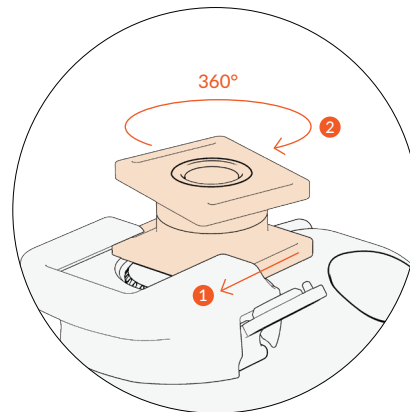
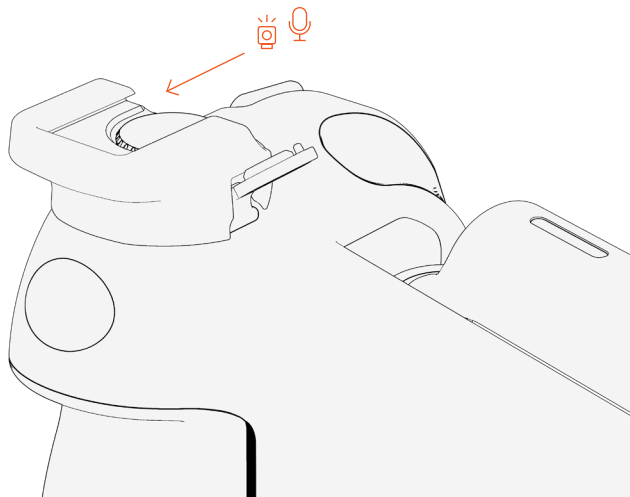

Cold Shoe Mount Adapter

If you want to adjust the angle the accessories face, add-on the rotatable Cold Shoe Mount Adapter.



User Manual

ShiftCam Warranty

We offer a 2-Year Warranty that covers your products from any manufacturing flaws or defects. Warranty does not cover damages from accidents or misuse.

2 Simple Steps to Get Your ProGrip Covered:

- 1) Scan the QR code and complete the warranty registration process.
- 2) In case of service required, please reach out to cs@shiftcam.com and send this warranty card along with your ProGrip back to us. We will get it fixed.



Safety Instructions

- Keep away from moisture and liquids. If ProGrip has been exposed

to liquids, dry immediately with dry cloth or tissue

- Do not open, remove, crush, puncture, or short-circuit ProGrip
- Do not use if visible defects are observed on ProGrip. Do not attempt to service or disassemble
- Using ProGrip for long periods of time will result in production of heat radiating from the device. It is a normal condition. If you believe your ProGrip may be overly heated please turn off the device immediately

Battery and Power

Battery Specifications

- Battery: 18650 Lithium Ion Battery Cell x2 pcs
- Capacity: 3.65V / 6400mAh / 23.36Wh
- Total power output: 20W Max
- USB-C In: PD 18W Max, DC9V/2A, 5V/3A
- USB-C Out: PD 20W Max, DC12V/1.5A, 9V/2.22A, 5V/3A (Max)
- Wireless Charging: 15W Max, 5W(DC5V/1A), 7.5W(DC9V/0.85A) 10W(DC9V/1.12A), 15W(9V/1.65A)

Charging ProGrip

To charge ProGrip:

- 1) Connect the USB-C cable included in the packaging to a power adapter plugged into a power outlet
- 2) Insert the USB-C cable to the USB-C port on the bottom of ProGrip

Wireless Charging

Turn on wireless charging function:

- 1) Press the Charging Button
- 2) A green LED light indicates the wireless charging function has been activated and entered into auto-detection mode
- 3) Attach your smartphone onto ProGrip securely, while aligning your smartphone centered to the wireless charging plate
- 4) ProGrip will auto-detect your smartphone once it is in place and begin charging. If fast charge mode is on, a red LED light will turn on simultaneously
- 5) Please double check your smartphone's battery indicator to ensure it is actively charging

Turn off wireless charging function:

- 1) Double-press the Charging Button
- 2) Green LED light will turn off, indicating that wireless charging function has been turned off

Note: The wireless charging function only works with smartphones that support wireless charging. Wireless charging may not work if you have a case that is (a) too thick, (b) has a magnet or metal, or (c) has built in charging function. If so, please remove the phone case before charging.

USB-C Charging

To access USB-C charging function:

- 1) Connect your accessory or smartphone to ProGrip using the USB-C cable
- 2) Plug in cable to USB-C port on ProGrip on one end, and connect the other end to your accessory or smartphone's power port
- 3) White LED lights will turn on, indicating that charging is active
- 4) Please double check your smartphone or accessory's battery indicator to ensure it is actively charging





To turn off USB-C charging function:

- 1) Double-press the Charging Button
- 2) White LED lights will turn off, indicating that charging function has been turned off

Checking ProGrip's Battery Power Level

- The white LED lights on ProGrip indicates its battery level
- To check ProGrip's battery level: Press the Charging Button, LED light indicating power level will appear

Attaching ProGrip to Your Smartphone

To attach ProGrip to your smartphone:

- 1) Align your smartphone to the center of the clamp, indicated by the markings on the clamp arms
- 2) Push down the lower arm with your smartphone to open up the clamp
- 3) Push your smartphone into the top arm and release the clamp to secure
- 4) To release your smartphone from ProGrip, open the clamp and remove your smartphone

Note: For smaller phone models with

width <75mm, add the Rubber In-Lay Attachments or Silicone Stoppers included in packaging onto the inside of the clamp to secure.

Connecting to Bluetooth Shutter

To connect bluetooth shutter:

- 1) Press the shutter button on ProGrip. The blinking blue LED indicates pairing mode is active.
- 2) Turn on the bluetooth pairing on your smartphone and select "ShiftCam ProGrip" to pair
- 3) A solid blue LED light indicates successful pairing
- 4) Click and shoot on your mobile using the shutter button

To reset bluetooth:

- 1) Press the bluetooth button and hold for 3 seconds to reset bluetooth
- 2) Blue LED light will start blinking, indicating bluetooth is in pairing mode.

The shutter button mirrors the functions of the camera button of your phone's primary camera app. Short press to take photo, long press to take burst/video

Sleep Mode: After 15 mins without pressing the shutter button, ProGrip will enter sleep mode. To reactivate, press the shutter button once

Hand Strap

To attach Hand Strap

- 1) Feed the end of the nylon strap from bottom up through the Hand Strap Loop, then feed the nylon strap back into the plastic buckle
- 2) Adjust length by pulling the nylon strings against the plastic buckles on top and bottom of the Hand Strap
- 3) Place the Hand Strap Attachment on the bottom of ProGrip aligned with openings, screw in knob to secure

Cold Shoe Mount

Mounting Accessories using Cold Shoe Mount / Cold Shoe Mount Adapter

- 1) Open the flap covering the Cold Shoe Slot on top of ProGrip
- 2) Place the Cold Shoe Mount above the opening then screw in knob to secure
- 3) To adjust the angle in which the accessory faces, add-on the rotatable

Cold Shoe Mount Adapter by sliding it into the mount

- 4) Attach accessories of your choice to the Cold Shoe Mount / Cold Shoe Mount Adapter accordingly

¼" Tripod Screw

Screw in to attach accessories into the ¼" screw thread on the bottom of ProGrip

Need Assistance?

Got a question about our products? Scan the QR code to submit an enquiry, or email us at cs@shiftcam.com and we would be happy to assist you. Happy shooting!



To learn more about ShiftCam, visit our official website at ShiftCam.com

ShiftCam ProGrip Regulator Compliance Information

FCC Statement: Declaration of Conformity with FCC Rules for Electromagnetic Compatibility

We ShiftCam Limited, declare under our sole responsibility that the product PG0001 to which this declaration relates, complies with Part 15 of the FCC Rules. Operation is subject to the following two conditions: (1) this device may not cause harmful interference, and (2) this device must accept any interference received, including interference that may cause undesired operation.

Federal Communication Commission Interference Statement

This equipment has been tested and found to comply with the limits for a Class B digital device, pursuant to Part 15 of the FCC rules. These limits are designed to provide reasonable

protection against harmful interference in a residential installation.

This equipment generates, uses, and can radiate radio frequency energy, and if not installed and used in accordance with the instructions, may cause harmful interference to radio communications. However, there is no guarantee that interference will not occur in a particular installation. If this equipment does cause harmful interference to radio or television reception, which can be determined by turning the equipment off and on, the user is encouraged to try and correct the interference by one or more of the following measures:

- Reorient or relocate the receiving antenna
- Increase the distance between the equipment and the receiver
- Connect the equipment to an outlet on a circuit different from that to which the receiver is connected
- Consult the dealer or an experienced radio/TV technician for help

FCC Caution

Any changes or modifications not expressly approved by the party responsible for compliance could void the user's authority to operate this equipment.

Radiation Exposure Statement

This equipment complies with FCC radiation exposure limits set forth for an uncontrolled environment. End users must follow the specific operating instructions for satisfying RF exposure compliance. To maintain compliance with FCC RF exposure compliance requirements, please follow operation instructions as documented in this manual. This equipment should be installed and operated with a minimum distance of 20 cm between the radiator and your body.

EU Compliance Statement

☑ ShiftCam Limited hereby declares that this product is in compliance with the essential requirements and other relevant provisions of the R&TTE Directive and Radio Equipment Directive 2014/53/EU, and all other applicable EU directive requirements.

Qi Q: BPP certified and compatible with EPP.

⌘ The WEEE symbol indicates that this product must not be disposed of with normal household waste. When you dispose of this product you must do so in accordance with local environmental laws and guidelines. For more information on how to dispose of this product please contact your local authority, disposal service, or ShiftCam Limited directly.



www.ShiftCam.com

 ShiftLens

 ShiftLens

